

Smoke Detector & Mini Dome Camera

Features

- Sony Super HAD II high sensitivity CCD sensor
- Built-in Cone Lens 3.7 mm
- DC voltage
- Option in-ceiling or surface mounting for RYK-2C54



RYK-2C54



RYK-26xx

Compact Size

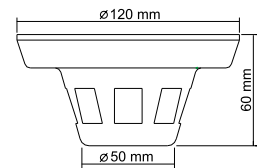
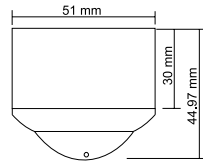
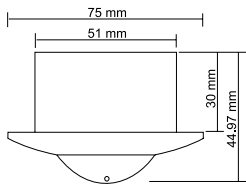

Model No.	RYK-2C54	RYK-2611	RYK-2683
Image Device	1/3" Color Sony Super HAD	1/3" Color Sony Super HAD II	1/3" Color Sony Super HAD II
Picture Elements(HxV)	NTSC:510x492, PAL:500x582		NTSC:768x494, PAL:752x582
Resolution	420 TVL		550TVL
Min. Illumination	0.1 Lux / F1.2	0.01 Lux / F1.2	0.02 Lux / F1.2
S/N Ratio	More than 48dB		
Electronic Shutter	NTSC:1/60~1/100,000 PAL:1/50~1/110,000		
Gamma	0.45		
Lens Furnished	Cone Lens 3.7mm / F2.0		
White Balance	Auto		
Gain Control	Auto		
Sync. System	Internal		
Video Output	1 Vp-p / 75 Ohms		
Audio Output	—	2 Vp-p / 50 Ohms (option)	
Power Supply	DC12V±10%		
Power Consumption	117mA max.	117mA max.	140mA max.
Operating Temp.	-10°C ~ 50°C		

Auto function is available for RYK-26xxA